

Copyright. This drawing and design and all the information contained therein is the sole copyright of Blik, and reproduction in any form is forbidden unless permission is obtained in writing.

CONTRACTORS PLEASE NOTE:

- 1) Warning; no dimensions to be scaled from this drawing. All Contractors must visit site and be responsible for taking and checking all dimensions relative to this work. The Designer must be advised of any discrepancies in writing.
- 2) This drawing must be read in conjunction with the Specification/Bill of Quantities and related drawings. Any structural work must be carried out to the exact specification and requirements of the Client's appointed Structural Engineer, and any amendments must have his express prior written authority.
- 3) All structural work must be inspected at all relevant stages by the Structural Engineer and the Local Authority's Building Surveyor and comply with their requirements. Any costs and claims for damages, loss of trade, etc. incurred by failing so to do are the sole liability of the Contractor.
- 4) Any discrepancies between drawings and specification should be reported to the Designer prior to any work commencing.

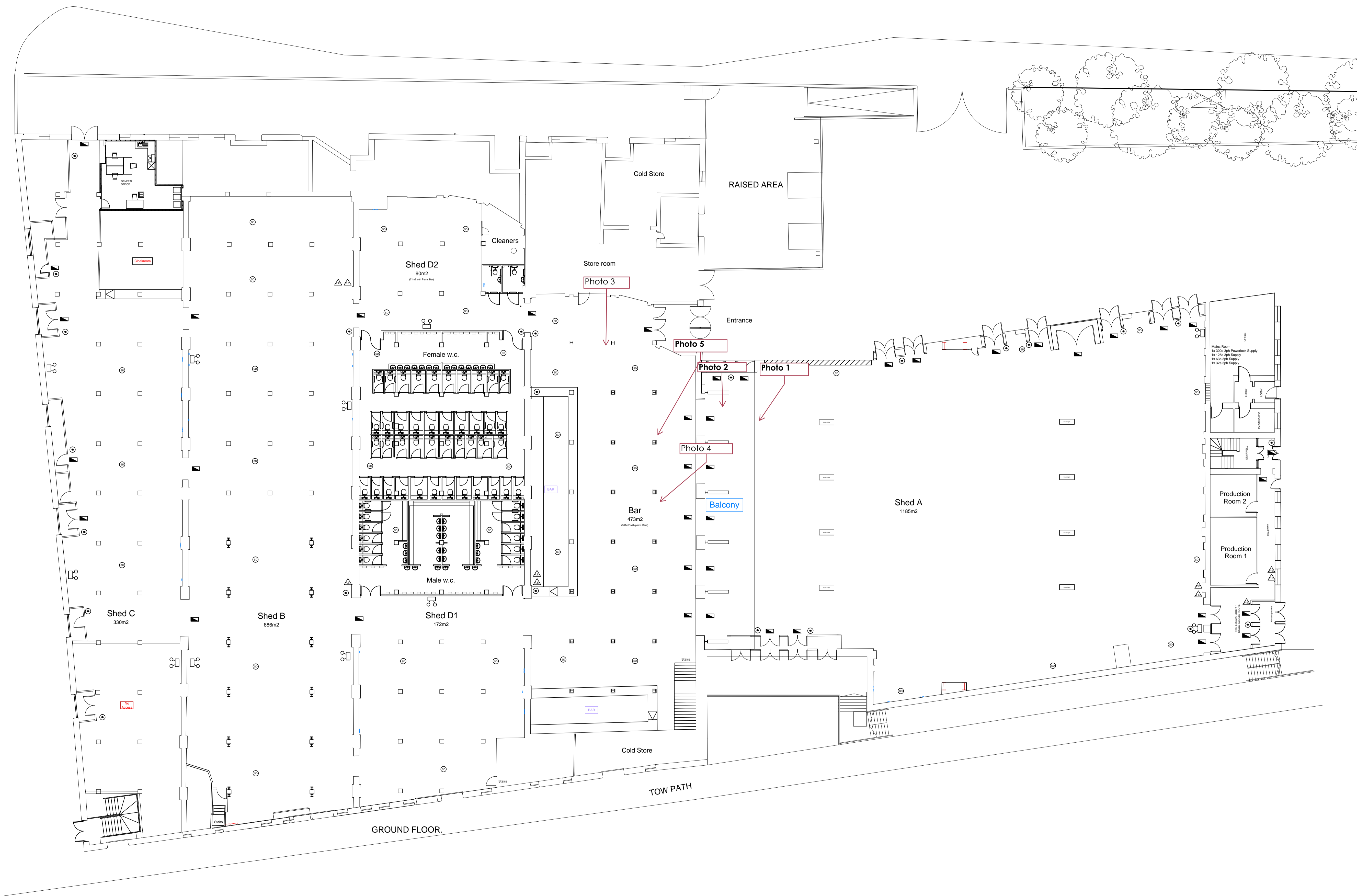

Rev A
new staircase shown. Office shown.

Revision: _____ Date: _____



Job title
**ACADEMY MUSIC GROUP.
Cotton Club - Manchester**

Drawing title
FIRST FLOOR LAYOUT

Scale 1:200	Drawing No.
Date Nov. 2018	850 / 01A
Drawn by	